

SEXTER® 信通

Mini Fiber Fusion Splicer

ST3100B



8s
Fast-splicing



18s
Fast-heating



3.5"
Color screen



0.01dB
Average loss

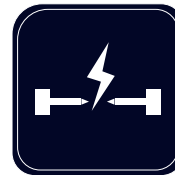

5000
Electrodes life



4 Motors
aligning

Main Features

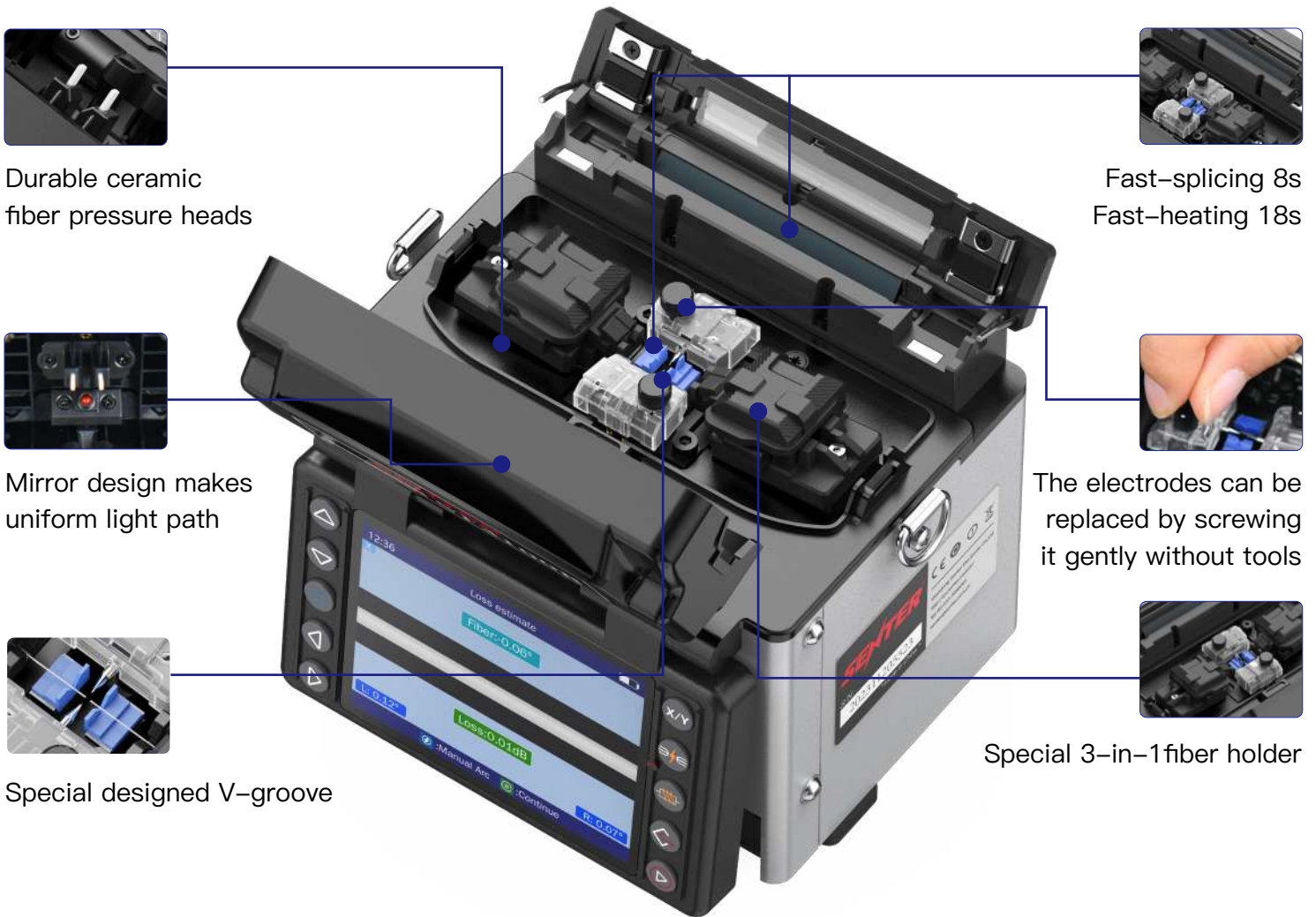

Feature Description

- Fast-splicing 8s, fast-heating 18s
- Average splicing loss 0.01dB
- Electrode life: 5000 times
- 3400mAh Battery capacity, 220 splice & heat cycles
- 3.5 Inch color screen
- 4 Motors aligning
- Compact, Light Weight & Faster
- 3-in-1 Fiber holder

3-IN-1 Fiber Holder

Fiber holder suitable for Bare Fiber/ 3.0mm Jump Fiber/ Pigtail Fiber/ FTTH Fiber



Rich expansibility

fiber optic cleaver operating platform (Optional)

Support the placement of cleaver operating platform, do cleaving and splicing work in one step
(Operation platform be ordered separately)

Suitable for different models
fiber optic cleavers

Cooling tray can be placed

Highly scalable

Invention patent application number 202210544729.X
Utility model patent application number 202221202906.8

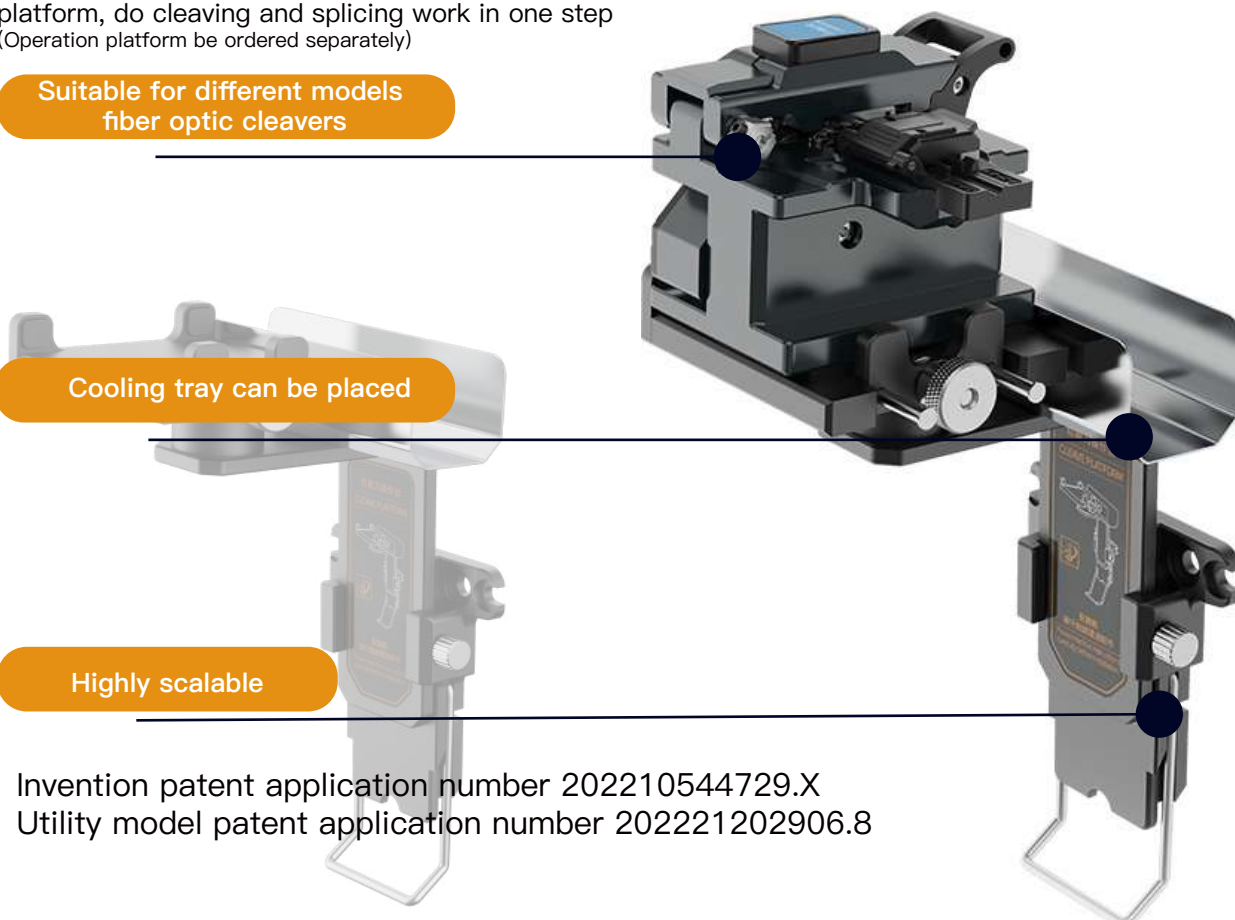

Installation instructions of fiber optic operating platform

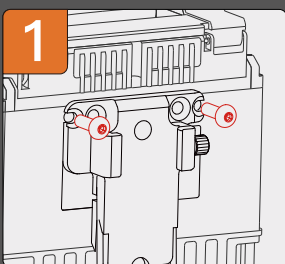

Install the fixing plate behind the fusion splicer with screws (M3/ M4/ M5).

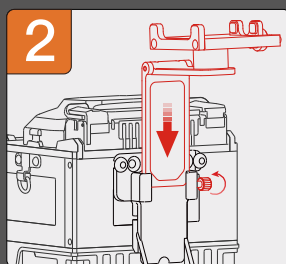

Insert the support plate into the fixing plate and tighten the fixing screws.

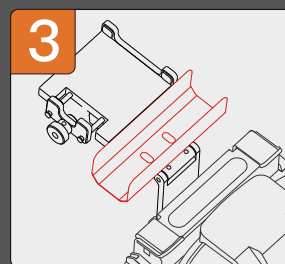

Place the cooling tray in the corresponding position of the support plate, and the installation is completed.

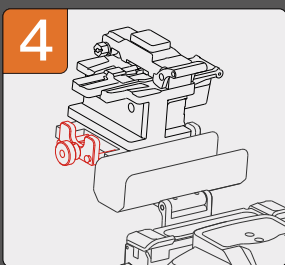

After placing the fiber cleaver on the operating platform, adjust the depth of the screw so that the rubber pad fits the cleaver completely.

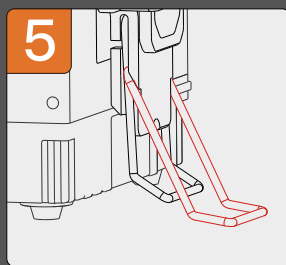

Pull the bracket vertically to the bayonet, and then pull it horizontally to support the machine on the table. (This step can be ignored for medium and large machines)

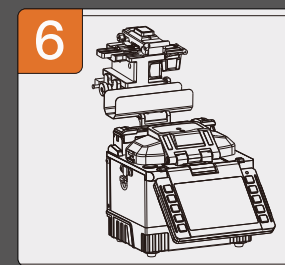

Now, the bracket installed on the fusion splicer for placing the cleaver and the cooling tray is installed.

Installation completion effect

*Operation platform
be ordered separately



3.5 inch LCD

Observe the X/Y axis fiber at the same time



Compact & light weight



220 splicing & heating cycles



3400mAh Battery capacity

Small size Big power



Specification

Splice Method :	Active Clad–Alignment
Applicable Fibers :	SM(ITU–T G.652&G.657) / MM(ITU–T G.651) / DS(ITU–T G.653) / NZDS(ITU–T G.655)
Compatible Fiber/Cable :	0.25~3.0 mm / indoor flat cable
Fiber Holder :	Replaceable
Fiber Diameter :	Cladding: 80–150µm, Coating: 100~1000µm
Fiber Cleave Length :	8~16 mm
Splice mode :	Max 128 modes
Typical Splice Loss :	SM: 0.03dB / MM: 0.01dB / DS: 0.04dB / NZDS: 0.04dB / G.657: 0.03dB ★①
Return Loss :	>>60dB
Splicing Time :	SM Quick mode : 8 sec / SM Average: 10 Sec
Estimated Splice Loss :	Available
Heating Time :	Quick mode 18 sec.(SM G652 250µm 40mm Sleeve) adjustable★②
Protection Sleeve Length :	20mm, 30mm, 40mm, 50mm, 60mm
Heat Programs:	Max 32 modes
Battery :	3400mAh Battery Capacity, Typical 220 Cycles (Splice&Heat) per Charge ★③
Electrode Life :	5000 arcs (replaceable) ★④
Auto–start :	Splice / Heating
Automatic Fiber Identification :	/
Automatic ARC Identification :	Automatic arc calibration by air pressure and temperature
Results Storage :	The last 10,000 splice records and 2,000 result images
Tension Test :	1.96~2.25N
Operating Condition :	Altitude: 0~5000m, 0~95% relative humidity, –20~50°C, Max Wind 15m/s
Storage Condition :	0~95% relative humidity, –20~60°C
Display :	3.5” color high resolution (800 x 480) display
Fiber Magnification :	X, Y, XY, X/Y : 320X Magnification
Power Supply :	AC 100–240V, DC 9–14V
Terminal :	USB2.0
Weight :	1.15kg without battery / 1.45kg with battery
Size :	125H x 105W x 113D mm

★① With identical fibres(in room temperature). Measured by cut–back method relevant to ITU–T and IEC standards.

★② 0.25mm fiber,may vary depending on the battery status and operating environment.

★③ Splice & Heat cycles based on 40mm shrink tube.

★④ Electrode life may vary depending on the operating environment.

Product Display



Packing List

- ① Fiber optic cleaver
- ② Carry bag (Including Suspenders & belts)
- ③ FOCW Cleaning wipes(box)
- ④ FPS-60 Splicing protector sleeves (piece)
- ⑤ Alcohol bottle
- ⑥ 3-hole fiber stripper
- ⑦ Drop cable stripper
- ⑧ Mini Fusion splicer
- ⑨ Power charger
- ⑩ Cooling Tray
- ⑪ Lithium battery

